



reedward

plastics (NW) limited

Units 1 & 2, Foxdenton Lane, Middleton Junction, Manchester M24 1RW

WHAT CAN WE DO FOR YOU?

Take a Look
inside and see
for yourself



**MASSIVE ON
SAVINGS ALL
OUR
PIPES & FITTINGS**

*AGAINST MANUFACTURER'S LIST PRICE



0161 655 4298

OPEN 6 DAYS A WEEK

**Next Day
Delivery**
on Most Orders

www.reedwardplasticsnw.com

Pipes

Available in

PVC-U, PP, ABS, PE & PVDF

Available in most materials to suit different needs & budgets.

Call us for up to date prices

0161 655 4298

Don't Forget Your Solvent Cements

We supply the entire Tangit cement range.

See Page 7



Class C

Available in up to 6 metre lengths in the diameters shown here

Metric also available

2"	5"
2½"	6"
3"	8"
4"	



Class D

Available in up to 6 metre lengths in the diameters shown here

Metric also available

1¼"	3"
1½"	4"
2"	



Class E

Available in up to 6 metre lengths in the diameters shown here

Metric also available

¾"	1¼"
½"	1½"
¾"	2"
1"	3"
	4"



Class T

Available in up to 6 metre lengths in the diameters shown here

Metric also available

¾"	1¼"
½"	1½"
¾"	2"
1"	

Fittings

All fittings are available in

PVC-U, PP, ABS, PE & PVDF

Choose your ends

Plain End
Plain to Threaded
Threaded to Threaded

Metric &
Imperial
available

Don't see what you need?

Fittings listed here are the most popular with our customers. However, this is not a complete list, if you don't see what you need, give us a call.

90° Elbow



3/8"	2 1/2"
1/2"	3"
3/4"	4"
1"	5"
1 1/4"	6"
1 1/2"	8"
2"	

90° Tee



3/8"	2 1/2"
1/2"	3"
3/4"	4"
1"	5"
1 1/4"	6"
1 1/2"	8"
2"	

45° Elbow



3/8"	2 1/2"
1/2"	3"
3/4"	4"
1"	5"
1 1/4"	6"
1 1/2"	8"
2"	

Cap



3/8"	2 1/2"
1/2"	3"
3/4"	4"
1"	5"
1 1/4"	6"
1 1/2"	8"
2"	

Socket



3/8"	2 1/2"
1/2"	3"
3/4"	4"
1"	5"
1 1/4"	6"
1 1/2"	8"
2"	

90° Swept Bend



3/8"	2 1/2"
1/2"	3"
3/4"	4"
1"	5"
1 1/4"	6"
1 1/2"	8"
2"	

0161 655 4298

Fittings

All fittings are available in

PVC-U, PP, ABS, PE & PVDF



Massive Range in Stock Quick Despatch

or available for instant pickup from our distribution centre

Union



3/8"	2 1/2"
1/2"	3"
3/4"	4"
1"	5"
1 1/4"	6"
1 1/2"	8"
2"	

Union Bush



3/8"	2 1/2"
1/2"	3"
3/4"	4"
1"	5"
1 1/4"	6"
1 1/2"	8"
2"	

Hose Adaptor



3/8"	2 1/2"
1/2"	3"
3/4"	4"
1"	5"
1 1/4"	6"
1 1/2"	8"
2"	

Union End



3/8"	2 1/2"
1/2"	3"
3/4"	4"
1"	5"
1 1/4"	6"
1 1/2"	8"
2"	

Stub Flange



3/8"	2 1/2"
1/2"	3"
3/4"	4"
1"	5"
1 1/4"	6"
1 1/2"	8"
2"	

Backing Nut



1/2"	2"
3/4"	3"
1"	4"
1 1/4"	
1 1/2"	

Fittings

All fittings are available in

PVC-U, PP, ABS, PE & PVDF

MASSIVE ON ALL OUR PIPES & FITTINGS
*AGAINST MANUFACTURER'S LIST PRICE

Best price promise

To give you the best possible price we work with low margins and adjust our prices based on our costs. So we can always offer you our best possible price.

Call us today - You'll be glad you did!

Reducing Bush



3/8"	2 1/2"
1/2"	3"
3/4"	4"
1"	5"
1 1/4"	6"
1 1/2"	8"
2"	

Blank Flange



3/8"	2 1/2"
1/2"	3"
3/4"	4"
1"	5"
1 1/4"	6"
1 1/2"	8"
2"	

Tank Connector



3/8"	2 1/2"
1/2"	3"
3/4"	4"
1"	5"
1 1/4"	6"
1 1/2"	8"
2"	

Barrel Nipple



3/8"	2 1/2"
1/2"	3"
3/4"	4"
1"	5"
1 1/4"	6"
1 1/2"	8"
2"	

Plug Threaded



3/8"	2 1/2"
1/2"	3"
3/4"	4"
1"	5"
1 1/4"	6"
1 1/2"	8"
2"	

Metric and Imperial sizes available



massive range in stock
ring now for today's awesome prices

0161 655 4298

Ball Valves

Don't see what you need?

The Ball Valves listed here are a big hit with our customers. However, this is not a complete list, if you don't see what you need, give us a call.

We stock branded valves

+GF+
GF Piping Systems

SAFI
Thermoplastic Valve Solutions

For more quality & peace of mind

Industrial



3/8"	1 1/2"
1/2"	2"
3/4"	2 1/2"
1"	3"
1 1/4"	4"

double union / plain socket EPDM Seals

Industrial



3/8"	1 1/2"
1/2"	2"
3/4"	2 1/2"
1"	3"
1 1/4"	4"

double union / plain socket EPDM Seals

Industrial



3/8"	2 1/2"
1/2"	3"
3/4"	4"
1"	5"
1 1/4"	6"
1 1/2"	8"
2"	

double union / plain socket EPDM Seals

Economy



3/8"	1 1/2"
1/2"	2"
3/4"	2 1/2"
1"	3"
1 1/4"	4"

double union / plain socket EPDM Seals

Economy



3/8"	2 1/2"
1/2"	3"
3/4"	4"
1"	5"
1 1/4"	6"
1 1/2"	8"
2"	

double union / plain socket EPDM Seals

Economy



3/8"	1 1/2"
1/2"	2"
3/4"	2 1/2"
1"	3"
1 1/4"	4"

double union BSP threaded socket EPDM

Adhesives & Cleaners



We supply the
Entire Tangit Cement Family
 For all your pipe cementing needs



Choose your product		PVC-U	ABS	PVC-C	PE	PP	PB	PVDF
Solvent Cements	Tangit All Pressure 250g / 500g	✓						
	Tangit Express 500g	✓						
	Tangit DTX 500g	✓		✓				
	Tangit ABS 650g		✓					
	Tangit PVC-C 650g			✓				
Cleaners	Cleaning Fluid 1 Litre	✓	✓	✓				
	KS Special Cleaning Fluid 1 Litre				✓	✓	✓	✓
	KS Cleaning Tissues 100 Pack				✓	✓	✓	✓

0161 655 4298

Backing Rings & Gaskets

Don't see what you need?

The backing rings and gaskets shown here are a popular purchase with our customers, if you don't see what you need, give us a call.

Backing Ring Galvanised Mild Steel



1/2"	2 1/2"
3/4"	3"
1"	4"
1 1/4"	6"
1 1/2"	8"
2"	

Drilled to BS10 Table D/E & ASA 150

Full Face Gasket



3/8"	1 1/2"
1/2"	2"
3/4"	2 1/2"
1"	3"
1 1/4"	4"

Backing Ring Galvanised Mild Steel



1/2"	20	2 1/2"	75	8"	225
3/4"	25	3"	90		250
1"	32	4"	110		280
1 1/4"	40	5"	140		315
1 1/2"	50	6"	160		
2"	63		200		

Drilled to BS4505 NP10/16

Flat Gasket



3/8"	1 1/2"
1/2"	2"
3/4"	2 1/2"
1"	3"
1 1/4"	4"

PVCU Backing Ring



50	160
63	200
75	225
90	250
110	315
125	400
140	

NP10 / 16

Industrial Plastics

Our specialised team

Our Industrial plastics meet very specific industry requirements. Our team can help you source the best materials for the job at the best prices.

Industrial Plastics Available as:

✓ Sheet ✓ Rod ✓ Block

Don't forget our fabrication services.

PVC



PETG

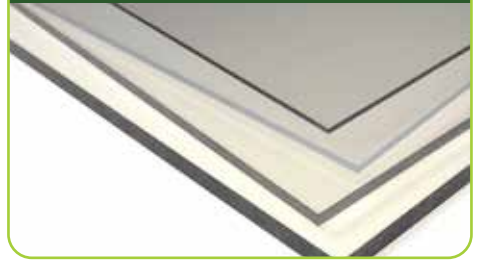

Polypropylene

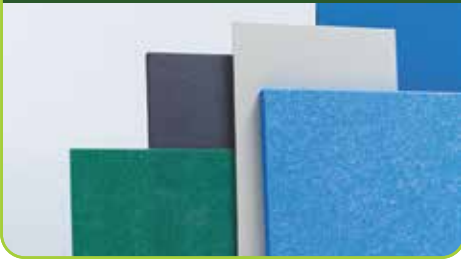

Polyethylene / HDPE



Polycarbonate

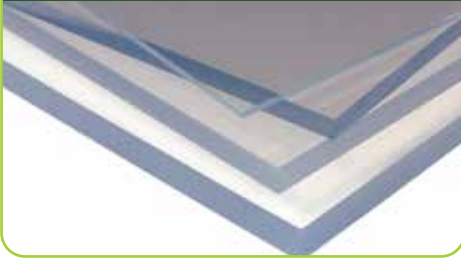

Nylon



0161 655 4298

Industrial Plastics

Working Temperatures

A handy reference guide for selecting plastic components based on the temperature needs during the lifetime of the material.

Figures based on the US Underwriters Laboratory (UL) for long term continuous use. They are the temperatures, which will cause the tensile strength of the material to reduce to half its initial value, when applied continuously for

100,000 hours (over 11 years)

		0	
PVC		-20	+50
PMMA	- Acrylic (Cast)	-40	+50
ABS		-35	+70
PA12	- Nylon 12	-50	+75
UHMW PE	- Ultra High Molecular Weight	-200	+80
PA6	- Nylon 6	-40	+80
HDPE	-High Density Polyethylene	-40	+80
PPE Mod	- Polyphenelene ether	-40	+85
PA6GF	- Nylon 6 Glass filled	-40	+85
POM	- Acetal Copolymer	-40	+90
PA 6.6	- Nylon 6.6	-30	+90
POM	- Acetal Homopolymer	-40	+95
PP	- Polypropylene	-5	+100
PC	- Polycarbonate	-40	+115
PET(P)	- Thermoplastic Polyester	-20	+115
PVDF Homo	- Polyvinylidene Fluoride	0	+150
PVDF Copol	- Polyvinylidene Fluoride	-40	+150
PSU	- Polysulphone	-40	+160
PEI	- Polyetherimide	~	+170
PTFE	- Polytetrafluoroethylene	-200	+180
PES	- Polyethersulphone	~	+180
PEEK	- Polyetheretherketone	~	+250
Phenolic	- Paper Laminates		+90
	- Fabric Laminates		+120
Epoxy	- Woven Glass		+140

Temperature range in degrees celsius

0161 655 4298

Designer Acrylics

Add some WOW factor!!

These sheets really add a touch of flare to any interior design or makeover project.

Phone for our full range of colours.

Glitter

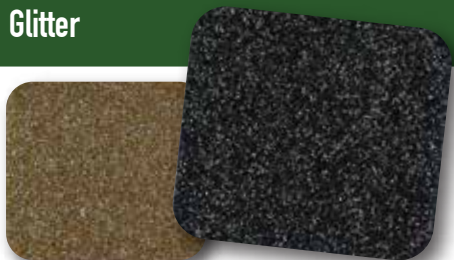

Glitz and glam. Perfect for funky bar interiors or adding pizzazz to kitchen surfaces. Acrylic sheet with glitter encased during manufacture for a smooth, high gloss, high sparkle, high wow finish.

Mirror



Mirror, mirror on the wall; who's the shiniest of them all?

A massive range of finishes & textures are available in a whole spectrum of colours to match every need. Need samples? No problem

Marble



For a more classic look, marble texture acrylics combine the ease of modern material with traditional styles

Pearl



Our pearl acrylics simply speak of class, with an organic pearl texture and pearlescent shimmer. It is refined yet distinctly glamorous.

Perspex®

Authorised Dealers

Reed Ward Plastics are official dealers of Perspex®
We hold a massive range in stock. Ready for exactly
when our customers need it.



Clear



Colour



Fluorescent

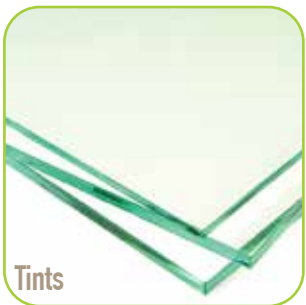

Tints



Frost

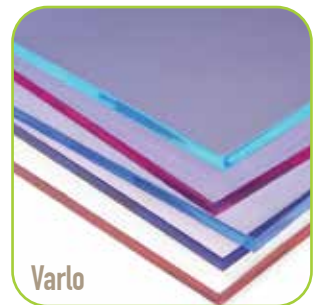

Varlo

0161 655 4298

Fabrication

The A-Team



We are the experts

With decades of experience, our elite squad of plastics engineers can fabricate bespoke sheet and piping components to meet your demands.

"I'm always happy to work closely with a client to make sure they get EXACTLY what they need."

Shaping

We can shape everything two dimensionally with special manual cutting tools from elegant curves to more complex irregular shapes. For the most intricate of shapes we can employ laser cutting techniques for super fine & precision cutting.

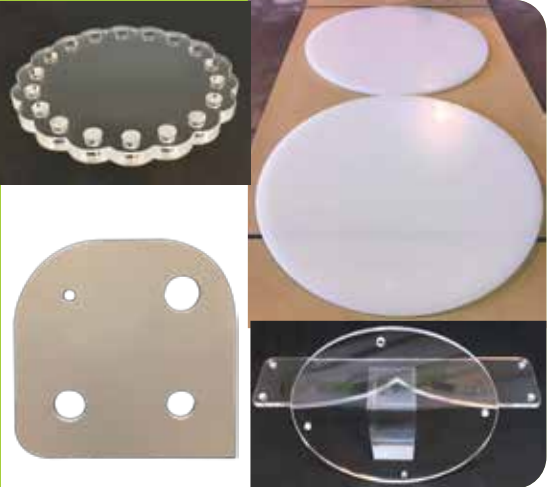

Cutting

We can cut sheet plastics and piping to the exact length or dimensions that your job requires, using our specially adapted workshop tools. So when it gets to the job site, it is ready to rock and roll. Saving you precious time, energy and aggravation.



Fabrication

Are you our next satisfied customer?

No job too big or small. Whether you're a national company, a home DIY enthusiast or an inventor looking for a prototype.

We have clients across many industries

Retail Display

Plastic Machine Components

Water treatment Industry

Interior Design

Public Services

Signage

Forming

We can bend & form plastic sheets in to 3D shapes in order to fulfill your specific requirements. Using a combination of techniques we can work with our customers to provide more complex & bespoke formed components.



Welding

Welding is a process used to join two pieces of plastic together as if it was a single unit. Creating a bond that is far beyond the scope of adhesives. Enabling us to create the highest quality, bespoke, plastic components for our customers, to meet their exacting requirements.



0161 655 4298

Pipe Brackets

Got what you need?

We stock pipe brackets in various types and various sizes. So whatever your job, we've got you covered.

Don't forget your Pipe Brackets when ordering your Pipe



Brushes

Reedward aims to be a one stop shop for all your pipe & plastic sheet needs, which is why we stock a quality range of brushes to help get the whole job done.

- Pure Bristle
- Perfect for Adhesives & Cleaners
- Available in a range of sizes

Don't forget your brushes when ordering your Adhesives & Cleaners

Camlock Adapter & Coupler

Our specialised team

Our Industrial plastics meet very specific industry requirements. Our team can help you source the best materials for the job at the best prices.

Female BSP threaded Adapter

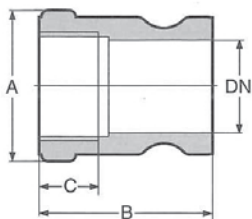

DN (mm)	DN (Inch)	A (mm)	B (mm)	C (mm)
15	½"	40	50	19
20	¾"	40	50	21
25	1"	50	57	20
32	1¼"	54	60	22
40	1½"	65	65	22
50	2"	75	75	25
80	3"	111	89	32

Male BSP threaded Adapter

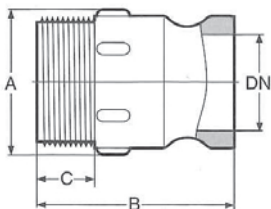

DN (mm)	DN (Inch)	A (mm)	B (mm)	C (mm)
15	½"	40	62	19
20	¾"	40	62	23
25	1"	50	72	25
32	1¼"	49	82	27
40	1½"	59	82	24
50	2"	68	88	28
80	3"	111	108	38

Hosetail Adapter

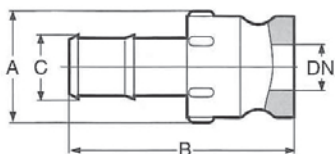

DN (mm)	DN (Inch)	A (mm)	B (mm)	C (mm)
15	½"	41	59	14
20	¾"	40	80	21
25	1"	46	99	27
32	1¼"	49	103	33
40	1½"	63	112	40
50	2"	73	128	52
80	3"	107	174	79

0161 655 4298

Female BSP threaded Coupler

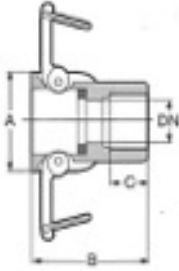

DN (mm)	DN (Inch)	A (mm)	B (mm)	C (mm)
15	½"	42	48	18
20	¾"	55	55	21
25	1"	64	60	20
32	1¼"	64	73	23
40	1½"	89	69	21
50	2"	94	80	26
80	3"	134	91	33

Male BSP threaded Coupler

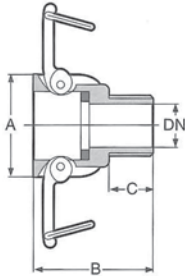

DN (mm)	DN (Inch)	A (mm)	B (mm)	C (mm)
15	½"	54	52	16
20	¾"	54	52	16
25	1"	63	65	25
32	1¼"	65	79	27
40	1½"	89	71	24
50	2"	94	81	28
80	3"	133	98	32

Hosetail Coupler

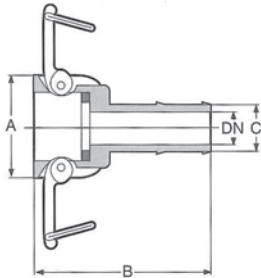

DN (mm)	DN (Inch)	A (mm)	B (mm)	C (mm)
15	½"	55	72	13
20	¾"	55	75	19
25	1"	63	95	25
32	1¼"	65	101	32
40	1½"	88	106	38
50	2"	93	123	50
80	3"	134	161	75

Dust Cap

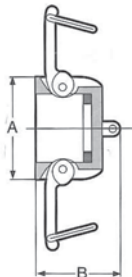

DN (mm)	DN (Inch)	A (mm)	B (mm)
15	½"	54	42
20	¾"	54	42
25	1"	63	51
32	1¼"	63	51
40	1½"	89	60
50	2"	94	66
80	3"	133	73

Two Way Ball Valves

DIN flanged compact, GRPP (also available in ANSI)

Can be actuated



DIMENSIONS					PN (bar)		
d	DN (mm)	DN (Inch)	L	H	EPDM	FKM	FEP/FFKM
20	15	½"	130	75	10	10	10
25	20	¾"	150	75	10	10	10

BS available on request

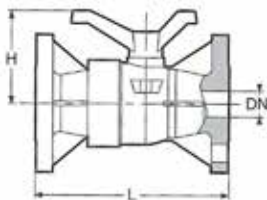

MARINE APPROVED

DIMENSIONS					PN (bar)		
d	DN (mm)	DN (Inch)	L	H	EPDM	FKM	FEP/FFKM
32	25	1"	160	95	10	10	10
40	32	1¼"	180	99	10	10	10
50	40	1½"	200	106	10	10	10
63	50	2"	230	111	10	10	10

In compliance with TA-Luft VDI 2440 / iso 15848 (FKM) - Marine Approved

Double union / BSP threaded socket, GRPP

Can be actuated



DIMENSIONS					PN (bar)			
d	DN (mm)	DN (Inch)	L	H	B	EPDM	FKM	FFKM
32	25	1"	136	78	23	10	10	6
40	32	1¼"	148	83	24	10	10	6
50	40	1½"	164	89	24	10	10	6
63	50	2"	172	95	24	10	10	6

OTHER FITTINGS

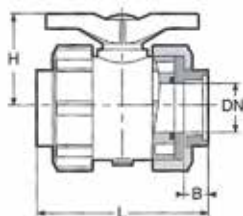

DN (mm)	Metric Plain Socket			UPVC Imperial Plain Socket (L)			HDPE Metric SPigot (Y)		
	L	H	B	L	H	B	L	H	B
25	136	78	23	136	78	23	136	78	23
32	148	83	24	148	83	24	148	83	24
40	164	89	24	164	89	24	164	89	24
50	172	95	24	172	95	24	172	95	24

Available with food grade EPDM^o ring compatible with European regulation 10/2011 on plastic materials and articles that are intended to come into with food

Actuators & Options



Safi Partner Promise

Reedward are Safi's distribution partners for the North. As such we can provide the keenest prices along with the best knowledge and expertise.

Valves with corrosion resistant pneumatic actuators

- Vane type actuators
- Rack & pinion actuator
- Options:
Limit switch boxes, Solenoid Valves, Manual override,
Positioners 3-15 PSI or 4-20mA available.
- Other actuators available on request



Valves with electric actuators

- Various electric actuators available in the following voltages; DC 12v, 24v, 48v and AC 110v, 240v, three phase 400v
- SAFI SM1 compact valve
- Options: Anti-condensate heater, potentiometers,
Battery back-up, Failsafe.
- Other actuators available on request



Options for manual operations

Lockable Handle



Extended Stern



Spring Return Handle



Reduction Gearbox



Come & Visit Us

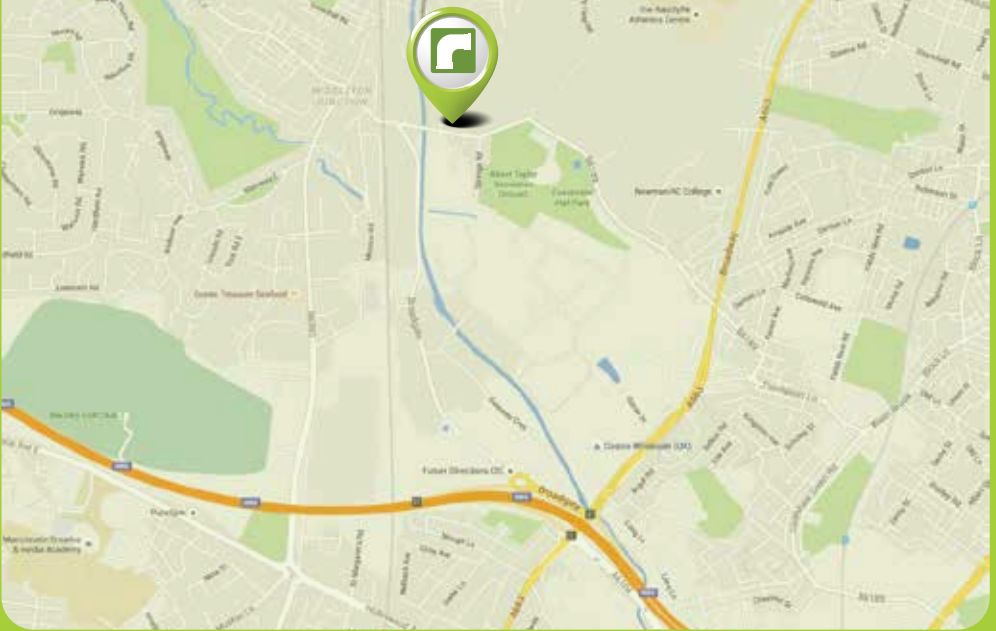

Sales Counter Now Open Open to Trade & Public Saturdays

We are located just a short distance from Junction 21 of the M60.
We are easily accessed from Broadway and Greengate. For Sat Nav users, our postcode is M24 1RW.

We also offer next day delivery on most orders.
You can just phone through an order, ring to get a competitive quote or to get some expert advice using the number below

Mon: 8:30am - 5:00pm
Tues: 8:30am - 5:00pm
Wed: 8:30am - 5:00pm
Thur: 8:30am - 5:00pm
Fri: 8:30am - 4:30pm
Sat: 9:00am - 12:30pm
Sun: Closed

Visit our website for more info:

www.reedwardplasticsnw.com

0161 655 4298